



2009 Wedding Planner

Stan Smith's
White **H**ouse **I**nn

178 Route 9 East
Wilmington VT 05363
800 541 2135

www.whitehouseinn.com



Basic Rates 2009 Weddings

These are the basic guidelines to consider in planning your special wedding. Please contact us for more detailed itinerary.

A \$900.00 deposit is required in order to confirm your reservation for the facility. A check or cash payment is accepted and is not refundable.

The facility fee is dependant upon the season and the number of guests attending the wedding. The fee may range from \$900 to \$2,000. In some instances we will reduce the facility fee for off-season weddings. Please find the enclosed rate sheet for our guest rooms. All room rates are based on double occupancy, each additional person in a room is \$15.00 per night.

A five hour open bar averages approximately \$38.00 per person. Your cost is based on actual consumption.

Champagne Toast with our house champagne is offered for \$3.50 per person.

Coffee & Punch are offered throughout the reception at a cost of \$2.50 per guest.

Hors d' Oeuvres vary by selection and average \$12.00 to \$18.00 per guest.

Entrees range from \$29 to \$38 per person and include salad, vegetable and side dish, such as rice or mashed potatoes.

All rooms, food, and liquor are subject to applicable state taxes and 20% gratuity. As the Inn is a licensed property, Vermont State Law requires all alcoholic beverages consumed in the public areas must be purchased from the Inn's bar.

Cakes, Flowers, Music, and Photographer are not included. We gladly provide you with a list of local professionals that have previously offered their services at the White House.

Chair Rentals for services are available for \$2.50 to include setup & take down.

Rehearsal Dinner barbecue is offered in our formal flower garden for \$25.95.

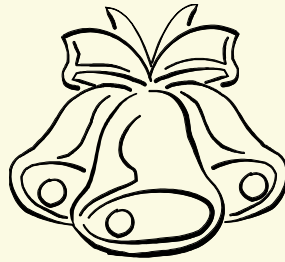

Sumptuous Samplings

Hors d' Oeuvres

Stuffed Mushrooms
Baked Brie
Home Baked Flat Breads
Smoked Canadian Lake Trout
Scallops Wrapped in Bacon
Shrimp Cocktail
Escargot & Brochette
Smoked Salmon
Ginger Chicken Skewers
International Cheese Board
Crab Cakes

Entrees

Grilled Salmon
Shrimp Newburg
Prime Rib
Filet Mignon
Lamb Loin
Pork Loin
Boneless Chicken Breast Barbara
Boneless Stuffed Duck *our specialty*
Vegetarian Dish

These items are not your only choices; rather they are included in order to give you an understanding of what we have done in the past. We are happy to consider your food requests during our consultations.

Why We Believe We Are...

The Premier Wedding Facility in Southern Vermont

Over the past 30 years of mounting weddings, we have learned no two weddings are the same.

Your wedding is exactly that, ***your*** wedding. We will assist you in making your perfect dream day a reality. We understand you have very particular ideas how some aspects of your wedding will be planned. After doing years of weddings we can help you with important details you perhaps have not considered. Our experience in assisting the planning of weddings will assure you of a day everyone will recall with fondness.

Without exception, THE WHITE HOUSE is the most scenic setting in southern Vermont for your wedding. Our formal flower gardens surround a bubbling fountain at the foot of an eight-columned arbor. Whether a tradition wedding or a Civil Union Ceremony it is under this picturesque arbor where couples most often recite their vows.

When you take into consideration the stately impression of the Inn and its architecture, surrounded by 16 acres of well-manicured lawns, flower gardens, fountains, and mountain views, it is readily obvious why the Boston Herald named, "THE WHITE HOUSE as one of the ten most romantic places in the world".

We believe the combination of our experience, scenic beauty, and romantic surroundings makes us,

.....Vermont's Premier Wedding Facility.

Function Scheduling

A \$900.00 deposit is required in order to reserve the facility. This deposit is not refundable. **Payment by check is required.**

Menu Selection

A preliminary menu selection should be discussed prior to reserving the facility. Final meal selection must be made prior to sending your invitations. Total number of guests to be invited must be confirmed with Inn. If more than one entree is selected you are responsible for an exact meal count for each entree. The enclosed list of entree's and hors d'oeuvres are for suggestion only. We have an outstanding culinary team and in most cases we are able to accommodate your specific selections.

Seating Place Cards

A final meal count is required 2 weeks prior to your wedding. Each guest must have their own place card if you are offering a choice of meals. You need to place their meal selection code on the back of these cards. We will work with you on table arrangements as soon as we receive your final meal count.

Function Hours & Facility Fee

The basic facility fee is \$900 for most moderate size weddings, unless otherwise noted. All functions are priced on a 5 hour facility fee with at least 75 guests in attendance. We can accommodate up to 85 guests for dinner in the inn. For larger numbers a tent can be rented that would bring the number of possible guests up to 250. Any additional time over the basic 5 hours incurs a \$200.00 to \$300 per hour charge. Additional service requests may cause the facility fee to go as high as \$2000. Use of the Inn and its services prior to reception is not included with the facility fee. Such use will be billed hourly. Termination of beverage service to any guest is at the sole discretion of the bartender. A \$500 damage deposit is required two weeks prior to your wedding. Any unused portion, in whole or in part, will be applied to your balance.

Tax & Gratuity

9% Vermont State Rooms & Meals Tax is added to all appropriate charges.

10% Vermont State Tax is added to all alcohol charges. A 20% Gratuity is added to the **final** bill. Additional gratuities for exceptional service are at your discretion.

Room Rental

You are responsible for renting all 16 rooms for two nights. Room rates are based on double occupancy. No reservations will be accepted until you submit your rooming form. Regretfully we are unable to offer any discounted room rates.

Alcohol

All beverages consumed on the property must be purchased through the Inn. This is a Vermont state law and is not flexible. Thank you for your understanding. The Inn's bar closes at midnight. All service ends at midnight.

Other Professional Services

Those services not offered by the Inn, such as floral arrangements, cake baker, photographer, and entertainment must be arranged by the wedding couple. We have provided a list of professional services available in our area. We welcome those not on our list to provide services at the inn. However, please understand that it is not the responsibility of the Inn to provide support for these professionals. We are extremely limited on our cold storage and generally unable to provide any space for cakes or flowers.

Check In

Check in is 2:00. We regret that we are unable to welcome your guests prior to check in. We are happy to greet the bride and groom at the hour of their convenience.

Alcohol and Wine

On occasion we are asked to serve a "favorite, or special" wine. Vermont State law requires us to purchase all wine from a licensed Vermont distributor. On request we will provide you with a list of all wines available through our distributors. Wine is sold throughout the country based on allocation. Wine that is sold in New Jersey may not even be available in Vermont. Your understanding in this matter is appreciated.

Termination of Agreement

Upon receipt of your deposit all 16 guest rooms are confirmed. Unless otherwise noted, you are responsible for payment for two nights stay for all 16 rooms. You are also responsible for full payment for the total reception costs. In the unlikely event of the cancellation of your use of the facility, a termination fee will be based upon the average cost for a 75 person wedding to include open bar. Submission of your deposit serves to confirm your agreement to these terms.

Professional Services

Music & Entertainment

Denning Disc Jockey Services	(800) 625-3622
Dorset Trio	(802) 440-4512
Peak DJ Services	(802) 888-6978
Harp & Flute Performance	(518) 692-9740
Ralph Thomas-harpist	(802) 375-6612
Laraine & Skip Morrow	(802) 464-5523

Photographers

Janice Boudreau	(413) 337-4033
Bob Story	(802) 464-5977
Amy Love	(888) 731-3686
Irene Goyette	(802) 447-1272

Wedding Cakes

Lisa Bigelow	(802) 258-2357
Amy's Bakery Arts	(802) 251-1071

Justice of the Peace

Wedding license Info	(802) 464-5836
----------------------	----------------

Civil Union Information for Vermont

<http://www.sec.state.vt.us/otherprg/civilunions/civilunions.html>

Florists

Fairview Gardens	(800) 792-1274
Boyd Family Farm	(802) 464-5618

Tents

Classical Tents	(800) 70-TENTS
-----------------	----------------

Inn Rooms

Room #1 Queen Bed, fireplace, up to 1 cot	\$184 per couple
<i>Guest Name</i> _____	
Suite Balcony, King Bed, sitting room, fireplace & fold-out couch, view	\$285 per couple
<i>Guest Name</i> _____	
Room #4 Queen Bed, can connect to suite, view	\$162 per couple
<i>Guest Name</i> _____	
Room #5 King Bed	\$168 per couple
<i>Guest Name</i> _____	
Room #6 Balcony, two queen beds, view	\$184 per couple
<i>Guest Name</i> _____	
Room #7 Two Queens, up to 1 cot	\$172 per couple
<i>Guest Name</i> _____	
Room #8 Queen Bed, can connect to room #9	\$175 per couple
<i>Guest Name</i> _____	
Room #9 Queen Bed, fireplace, up to 1 cot, can connect #8	\$184 per couple
<i>Guest Name</i> _____	
Room #10 Queen Bed	\$167 per couple
<i>Guest Name</i> _____	
Room #11 Queen Bed, fold-out couch	\$172 per couple
<i>Guest Name</i> _____	
Room #12 Sitting area with queen fold-out couch, fireplace, stairway to loft with queen bed	\$178 per couple
<i>Guest Name</i> _____	
Room #14 Sitting area with queen fold-out couch, fireplace, stairway to loft with queen bed	\$178 per couple
<i>Guest Name</i> _____	
Room #15 Balcony, Queen Bed, fireplace, whirlpool bath	\$184 per couple
<i>Guest Name</i> _____	
Room #16 Balcony, Queen Bed, fireplace, whirlpool bath	\$184 per couple
<i>Guest Name</i> _____	
Room #111 Balcony, Queen Bed, fireplace, whirlpool bath	\$184 per couple
<i>Guest Name</i> _____	
Room #112 Balcony, Queen Bed, fireplace, whirlpool bath	\$184 per couple
<i>Guest Name</i> _____	

Additional occupancy requires \$30 additional charge per night.

9% Rooms and Meals Tax added to final bill. Please note that these room rates **only apply to spring and summer. All fall and winter rates are higher.**

Churches

Jacksonville Community Church	368 7626
Newfane Congregational Church	365 4626
Our Lady of Fatima	464 7329
Wilmington Congregational Church	464-2736
East Dover Baptist	348 6366

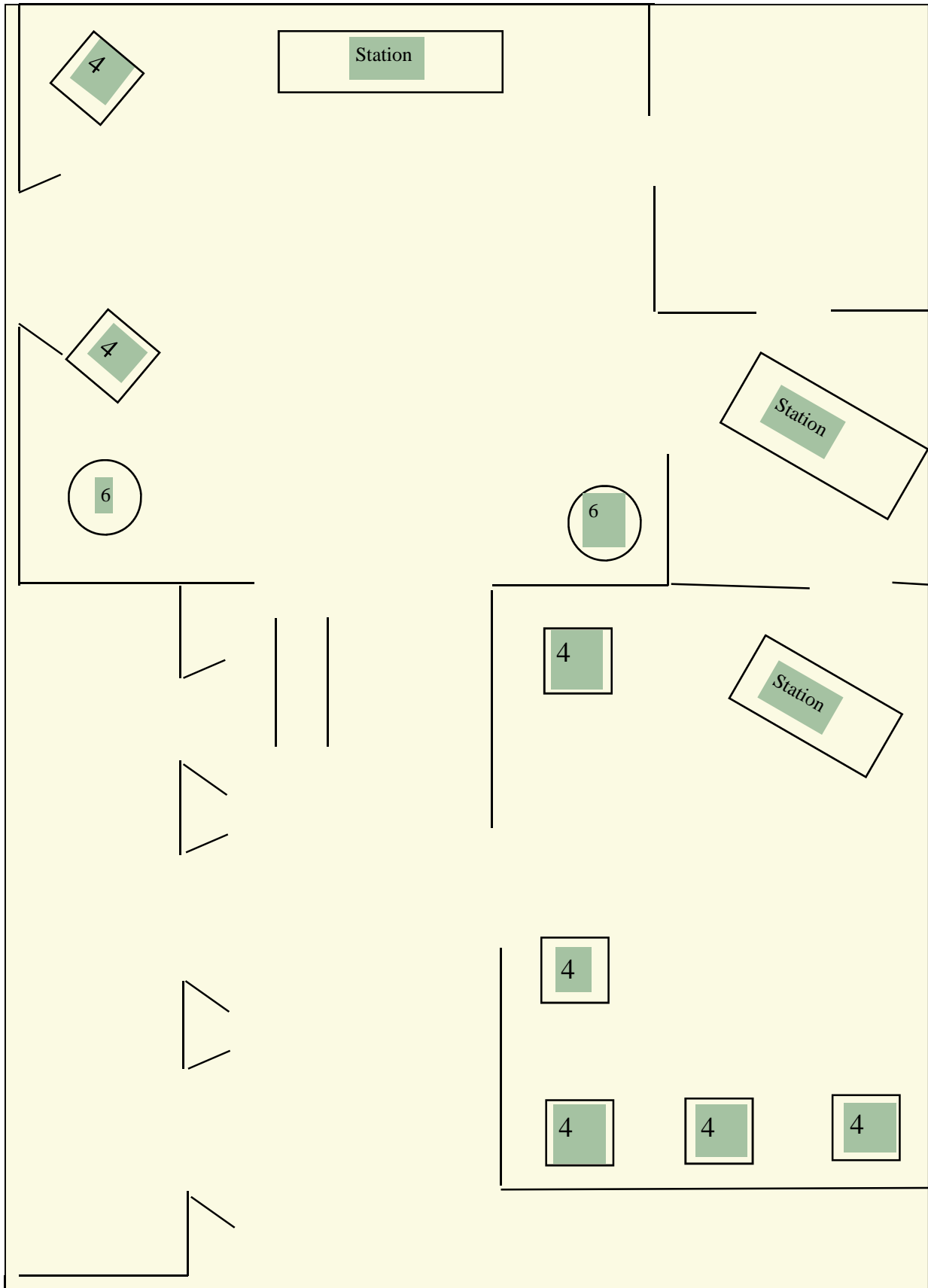

Tent May have up to two stations, bar & Cake table

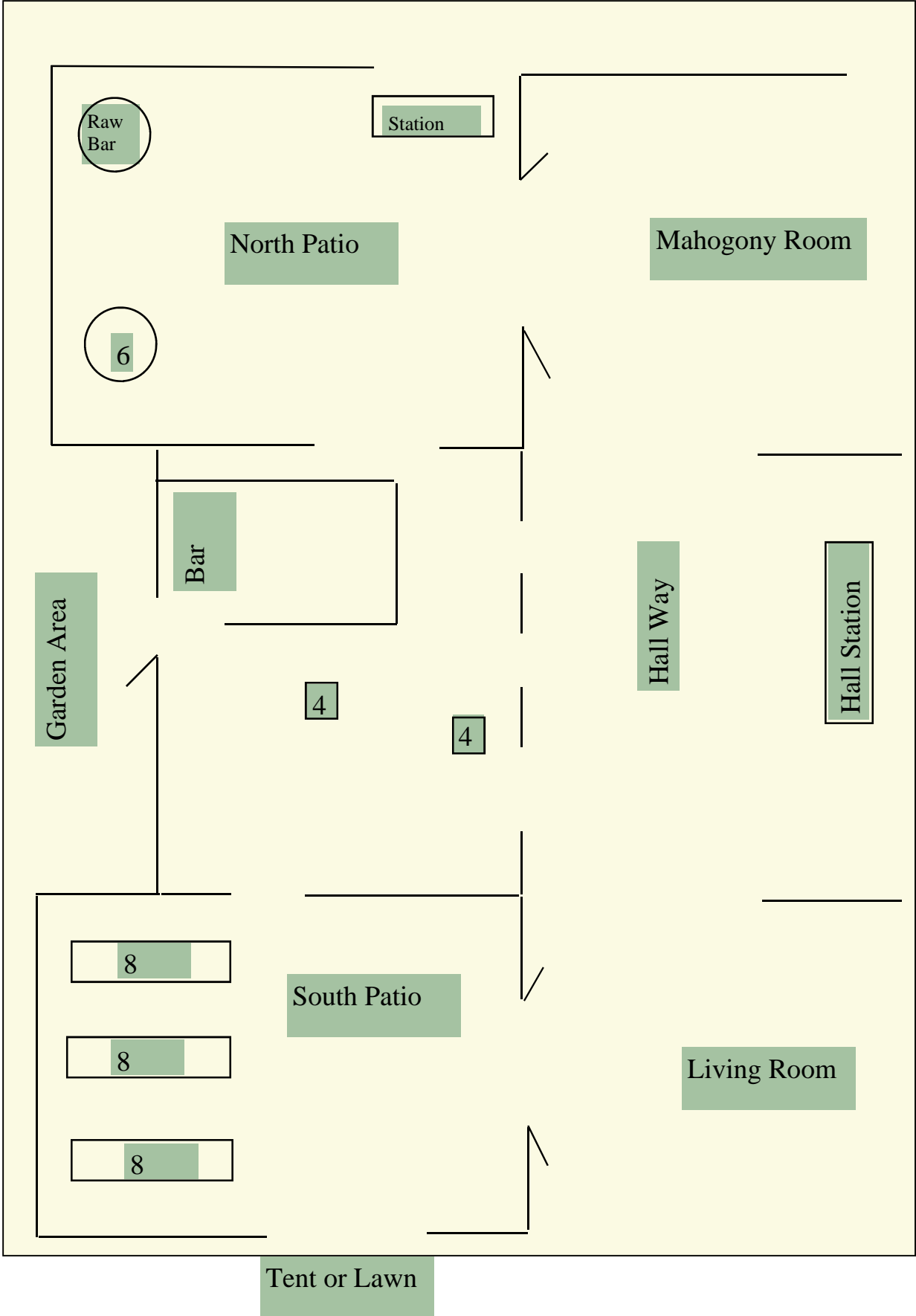

Tables By Room

Mahogany Room

1	6' or 8' Station		
2	Rounds @ 6 each		12
2	Square @ 4 each		8

Jefferson Room

1	12' Banquette		12-14
	or		
1	Round	@ 6 each	6
2	Square	@ 3 each	6

Gold Room

1	6' Station		
5	Square	@ 4 each	20

North Patio

1	Raw Bar		
1	8' Station		
1	Round	@ 6 each	6

Bar Area

14		@ Bar itself	
1	Square	@ 4 each	4

South Patio

3	8' Banquette	@ 8 each	24
---	--------------	----------	----

Tent

1	Cake Table		
1	Bar		
1	8' Station		
8-20	Rounds @ 8 each		64-160

Sample Grazing I

Friday

- 2:00 Check In
- 5:00? Rehearsal

6:00? Barbecue in Gardens *approximately 50 Guests*

Hamburger, hotdogs, sausage, pork loin, chicken, portabella mushrooms, corn, potato & pasta salad, grilled vegetables, lemonade.

Coffee & Dessert to be included and served inside.

Bar can be either Hosted or a Cash Bar

Saturday

- 8:00 to 9:30 Breakfast for all registered guests
- 4:00 Ceremony (10-15 Chairs on each side)
- 4:30 to 8:30 Facility Rental \$1000
- Additional Hour \$200
- 4:30 Photographs
- 4:30 Coffee & Punch
- 4:30 Hosted Bar and Hors D' Oeuvres

Hors D'oeuvres

Stuffed Mushrooms
Puffed Pastries (spinach and Garlic)
Shrimp Cocktail
Bruschetta with Mozzarella
Cheese Table (to remain out during grazing)
Fruit Tray (with Cheese Table)

5:30 Begin Grazing

Grazing Stations

It is important to understand there will be a fixed amount of food available at each station. This will work out to the equivalent of 1-½ entrees per person. Inherent in this type of service is the fact we will run out of one station prior to others. All of these stations will be manned during the dinner hour. (Around 1 1/2 hours)

Carving Table

Prime Rib

Chilean Sea Bass (Lemon, Wine, Butter, and Garlic) *{market price}*

Chicken Saltimbocca

Green Beans with garlic

Roasted Red potatoes

Eggplant Parmesan

Pasta Table

Hand-tossed pasta.

Penne

Cheese Tortellini

Alfredo

Pesto

Marinara

Vodka Sauce

Broccoli, Cauliflower, diced tomato, Mushrooms, peas, grated cheeses, prosciutto, and herbs.

Salad Station

Bowl of Mixed Greens with Wild Flowers and Mesculin

Assorted Dressings, Oil and Vinegar, Chopped Vegetables, grated cheese, croutons, pepper mill.

Bread

7:30 Champagne Toast

7:35 Cake Cutting

8:30 Facility Rental Ends

9:30 Additional Hour Expires Reception Ends

Only one additional hour may be reserved..

12:00 Bar to Close

Sample Grazing II

Hors D'oeuvres

Puffed Pastry
Scallops & Bacon
Smoked Trout
Assorted Bruschetta
Spring Rolls
Cheese Table (to remain out during grazing)

Coffee & Punch

8:30 Begin Grazing

Grazing Stations

Carving Table

Filet Mignon
Béarnaise Sauce
Mushroom Sauce
Horseradish Cream Sauce

Roasted Red Potato

Pasta Table

Hand-tossed pasta.
Penne
Cheese Tortellini

Alfredo
Pesto
Marinara
Vodka Sauce

Broccoli, Cauliflower, diced tomato, Mushrooms, grated cheeses, prosciutto, and herbs.

Cheese Table

The following to be added to the Cheese Table:

Assorted Breads
Prosciutto
Olives
Roasted Peppers
Cold Marinated Grilled Vegetables
Marinated Asparagus

Salmon & Chicken

Poached Salmon
Chicken Marsala

- *10:15 Cut Cake*
- *12:00 Reception Ends*

Sunday

8:00 to 10:00 Breakfast for all registered guests

- 11:00 Check Out

Sample Sit-Down

Friday June

- 2:00 Check In
- 5:00? Rehearsal

6:00? Barbecue in Gardens *approximately 50 Guests*

Hamburger, hotdogs, sausage, pork loin, chicken, portabella mushrooms, corn, potato & pasta salad, grilled vegetables, lemonade.

Coffee & Dessert to be included and served inside.

Hosted or Cash Bar

11:00 Close Bar

Saturday June

- 8:00 to 9:30 Breakfast for all registered guests
- 3:00 Ceremony (10-15 Chairs on each side)
- 3:00 to 8:30 Facility Rental
- Additional Hour
- 3:30 Photographs
- 3:30 Coffee & Punch
- 3:30 Cash Bar and Hors D' Oeuvres

Hors D'oeuvres

Stuffed Mushrooms
Puffed Pastries (spinach and Garlic)
Shrimp Cocktail
Bruschetta with Mozzarella
Cheese Table (to remain out during grazing)
Fruit Tray (with Cheese Table)

- 5:00 **Dinner**

Choice of Entrée average

- 6:30 Dancing Begins
- 7:30 Champagne Toast
- 7:35 Cake Cutting
- 8:30 Facility Rental Ends
- 9:30 Additional Hour Expires Reception Ends

Only one additional hour may be reserved..